

FRONT VIEW

SIDE VIEW

BACK VIEW

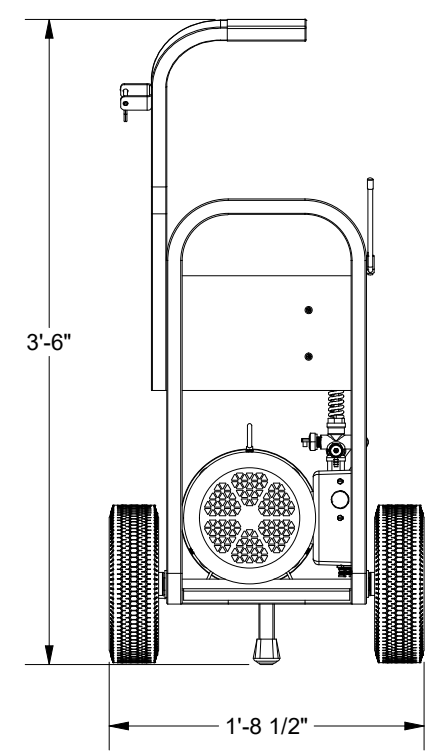
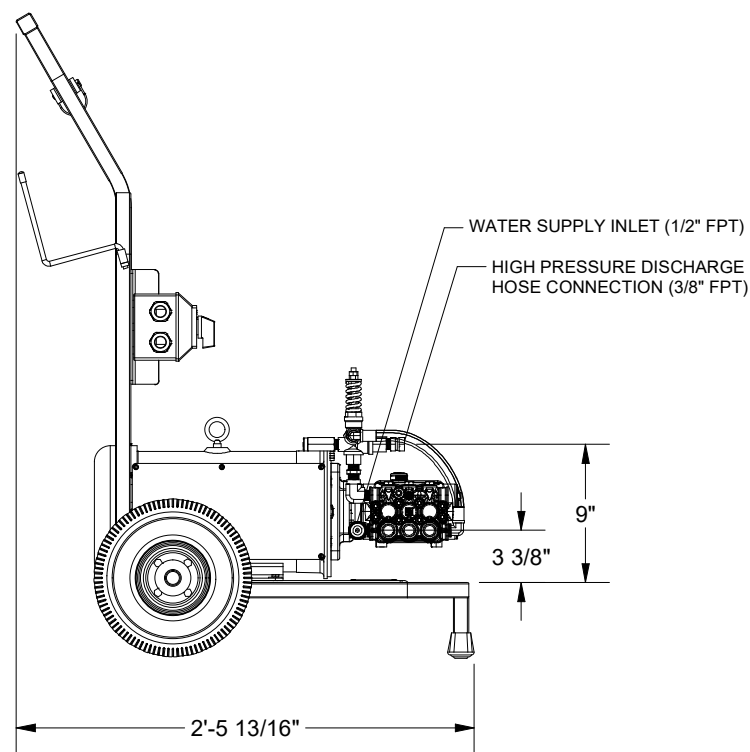
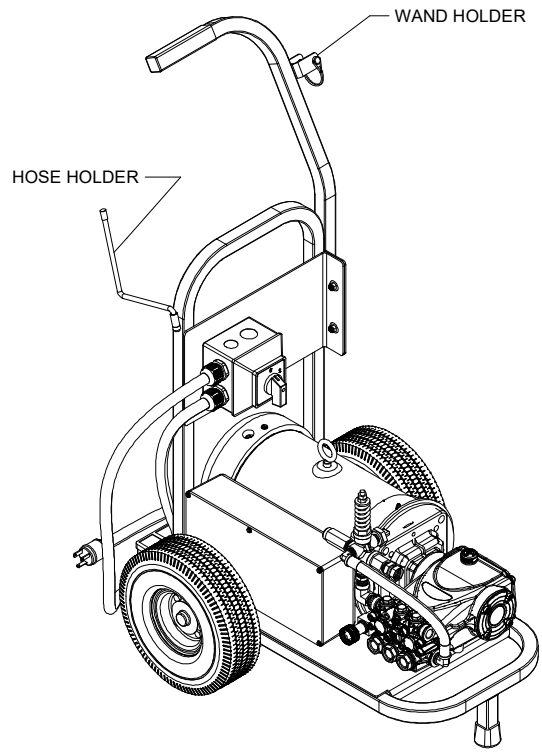

OPTIONAL FEATURES

- 15', 25', 30' OR 50' DISCHARGE WAND HOSE
- 8' WATER INLET HOSE
- SOAP INJECTION

NOTES:

1. POWER REQUIREMENTS

POWER SUPPLY TO BE SUPPLIED ON SEPARATE PROTECTED CIRCUIT BY OTHERS PER REQUIREMENTS LISTED ON SPECIFICATIONS TABLE

2. PLUMBING CONNECTIONS

-WATER REQUIREMENTS

SHUT-OFF VALVE (PROVIDED BY OTHERS) REQUIRED AT WATER SUPPLY INLET LOCATION

MINIMUM WATER SUPPLY SHALL BE PROVIDED AT GREATER GPM THAN AS LISTED IN SPECIFICATION TABLE AND 25-75 PSI

3. OTHER SPECIFICATIONS

GFCI POWER CORD LENGTH: APPROX. 25'
STANDARD UNIT WEIGHT: APPROX. 200 lbs
DUAL NOZZLE VARIABLE PRESSURE WAND

SPECIFICATIONS TABLE

MODEL (GPM/PSI)	PHASE	HP	VOLTAGE	AMPERAGE
2.5/3000	1 PH	5	230	23

UNLESS OTHERWISE INDICATED:
DIMENSIONS ARE IN INCHES.
REMOVE ALL BURRS & SHARP EDGES.

TOLERANCES AS FOLLOWS:
± .1" ON ANGLES

DRWN	DATE
JFS	08/30/22
REVISED	DATE
JFS	08/31/22
APPR	DATE
DESIGNER(S)	
JACOB S.	



DWG TITLE

DIMENSIONAL SPECS, 2.5/3000EI

HYDRO ENGINEERING INC.
865 W. 2800 S., SALT LAKE CITY, UT 84119

PROJECT / DWG TYPE

DIMENSIONAL SPEC.

DWG FILE

W:\CAD\SPECS\HB\EC-EI\

VAULT FILE

SD2.5-3000EI.idw

DWG PIN

SD2.5-3000EI